

## Manual Motor Starter Ex9S32 Accessories: Selection Guide

### Selection

Ex9S	AX51	A	G
NOARK Ex9S32 Series	Description	Auxiliary Contact	Rated Voltage
	AX51: Auxiliary contact (front mount only) AX52: Auxiliary contact (left side only) AL51: Fault Signaling Contact (left side only) UVT51: Undervoltage release (right side only) SHT51: Shunt release (right side only) CCT51: Adapter	11: 1NO+1NC (AX51,AX52,AL51) 20: 2NO (AX51,AX52) 02: 2NC (AX52)	A: 100~130V 50/60Hz(SHT51) 110~120V 60Hz(UVT51) B: 190~330V 50/60Hz(SHT51) 110~120V 50Hz & 127V 60Hz(UVT51) C:330~440V 50/60Hz(SHT51) 208V 60Hz(UVT51) D: 480~500V 50/60Hz(SHT51) 240V 60Hz(UVT51) E: 575~600V 50/60Hz(SHT51) 480V 60Hz(UVT51) F: 600V 60Hz(UVT51) G: 220~240V 50Hz(UVT51) H: 380~415V 50Hz(UVT51)

CC	51
Description	Type
Combination Block	51:Ex9CS 12A 52: Ex9C 9-18A 53: Ex9C 25-38A

DRA	51
Description	Type
Mounting Bracket	51: for mounting Ex9S32 with Ex9C 9-38A

ERH	51	B
Description	Type	Color of Handle
Extended Rotary Handle	51: for Ex9S32	B: Black/Gray Y: Yellow/Red

WPB	51	B
Description	Type	Color of Handle
Waterproof Enclosure	51: with rotary handle	B: Black/Gray Y: Yellow/Red

WPB	52
Description	Type
Waterproof Enclosure	52: Flush, with protective cover

## Manual Motor Starter Ex9S32 Accessories: Specifications

Description	Mounting Location	Max. No. of Blocks	Contact Type	SKU
Instantaneous auxiliary contacts	Front	1	NO+NC	AX5111
			NO+NO	AX5120
	Left Side	2	NO+NC	AX5211
			NO+NO	AX5220
			NC+NC	AX5202
Fault Signaling Contact		1	NO+NC	AL5111

AX51



AX52



AL51



### Electrical Trip Unit

Description	Mounting Location	Voltage	Hz	SKU
Undervoltage Release	Right Side	110-120V	60	UVT51A
		127V	60	UVT51B
		110-120V	50	UVT51B
		208V	60	UVT51C
		240V	60	UVT51D
		480V	60	UVT51E
		600V	60	UVT51F
		220-240V	50	UVT51G
Shunt Release	Right Side	380-415V	50	UVT51H
		100-130V	50/60	SHT51A
		190-330V	50/60	SHT51B
		330-440V	50/60	SHT51C
		480-500V	50/60	SHT51D
575-600V	50/60	SHT51E		

UVT51

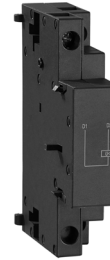

SHT51



### Terminal Block

Description	Mounting Location	Pole	SKU
Large spacing, UL 508 Type E	Line-in Side	3	CCT51

### Busbars

Description	No. of Ex9S32 Starter	No. of Side-Mounted Aux Contact on each Ex9S32 starter	Busbar Pitch (mm)	SKU
Sets of 3-pole, 63A Busbar	2	None	45	CBB51A20
		1 of AX52, AL51	54	CBB51B21
		2 of AX52, AL51 or 1 UVT51, SHT51	63	CBB51C22
	3	None	45	CBB51A30
		1 of AX52, AL51	54	CBB51B31
		2 of AX52, AL51 or 1 UVT51, SHT51	63	CBB51C32
	4	None	45	CBB51A40
		1 of AX52, AL51	54	CBB51B41
		2 of AX52, AL51 or 1 UVT51, SHT51	63	CBB51C42
	5	None	45	CBB51A50
		1 of AX52, AL51	54	CBB51B51
		2 of AX52, AL51 or 1 UVT51, SHT51	63	CBB51C52

Ex9S32 + CC53 + Ex9C32 + DRA51



DRA51



### Wiring Accessories

Description	Application	SKU
Input Terminal for CBB51 Busbar	Terminal block for power supply to one or more CBB51 bus bar	FD51
Protective end cover	For unused busbar outlets	PC51

### Mounting Accessories

Description	Application	SKU
Combination Block	Between Ex9S32 and Ex9C Mini Type Contactor, 09-12A	CC51
	Between Ex9S32 and Ex9C Standard Type Contactor, 09-18A	CC52
	Between Ex9S32 and Ex9C Standard Type Contactor, 25-38A	CC53
Mounting Bracket	For mounting a Ex9S32 to a Ex9C Standard Type Contactor, 09-38A	DRA51

CC53



### Enclosures

Description	Type	Color	Rating	SKU
Waterproof Enclosure; Ex9s32 Protectors	Operation by rotary handle	Black/ Gray	NEMA 4X/4, IP 65	WPB51B
		Yellow/ Red		WPB51Y

### Operation Handle

The extended rotary handle makes it possible for a door-mounted rotary handle to operate starter installed on the inside back panel of an enclosure. The extended rotary handle consists of the following:

- a set of screws onto the handle of the starter
- an assembly (handle and front plate) that fits on the enclosure door
- an extension shaft which must be adjusted according to the distance between the mounting surface and the door: 9 inch (230 mm)
- a bracket that install with starter and the shaft through

Description	Type	Color	Rating	SKU
Extended Rotary Handle	9 inch (230mm) shaft, with bracket	Black/ Gray	NEMA 4X/4, IP65	ERH51B
		Yellow/ Red		ERH51Y

# Manual Motor Starter

## Ex9S32 Accessories: Packaging and Specifications

Part Number	Product's N.W. (g)	Inner Box			Carton		
		Qty/box (pcs)	Dimensions (mm)	G.W. (g)	Full Carton Qty (pcs)	Dimensions (mm)	G.W. (kgs)
AX51	16	10	81x63x58	189	720/72	405x265x265	14.2
AX52	42	2	98x82x27	106	192/96	415x240x285	10.8
AL51	43	1	98x82x27	65	96/96	415x240x285	6.9
UVT51	125	1	98x82x27	147	96/96	415x240x285	14.8
SHT51	102	1	98x82x27	124	96/96	415x240x285	12.6
CCT51	54	6	144x112x65	396	144/24	353x292x314	10.3

## Technical Data

	Auxiliary contacts - AX51	Auxiliary contacts - AX52	Auxiliary contacts - AL51	Shunt Release - SHT51	Undervoltage Release - UVT51	Adapter - CCT51
Rated operational voltage Ue	300V	600V	600V			
Rated frequency	50/60Hz	50/60Hz	50/60Hz	50/60Hz	50/60Hz	50/60Hz
Rated impulse withstand voltage Uimp	6000V	6000V	6000V			
Conventional rated thermal current (Ith)"	2.5A	5A	5A			
Mechanical life (C-O operations)	100000	100000	100000			
Electrical life (C-O operations) (for AC-3 duty) (for AC-3 duty)	AC-15 : 10,000	AC-15 : 10,000	AC-14 : 1000			

## Terminal Wiring

Ex9S32 Main Terminal	Screw Type	M4, Phil-Slot head
	Pull wire length inch (mm)	
Wire range AWG		(1)x14-(2)x8
Torques in-lb (N.m)		1.85 (2.5)

Model	Wire Ranges(AWG)	Torques in-lb (N.m)	Screw Type	Phil-Slot Head
AX51	(1)x18-(2)x12	0.59 (0.8)	M3	
AX52	(1)x18-(2)x12	0.59 (0.8)	M3	
AL51	(1)x18-(2)x12	0.59 (0.8)	M3	
UVT51	(1)x18-(2)x12	1.254 (1.7)	M3.5	
SHT51	(1)x18-(2)x12	1.254 (1.7)	M3.5	
CCT51	(1)x14-(2)x8	1.844 (2.5)	M4	

## Manual Motor Starter Ex9S32 Accessories: Dimensions

### Ex9S32 + CC51 + Ex9CS06, 09, 12

Unit: in [mm]

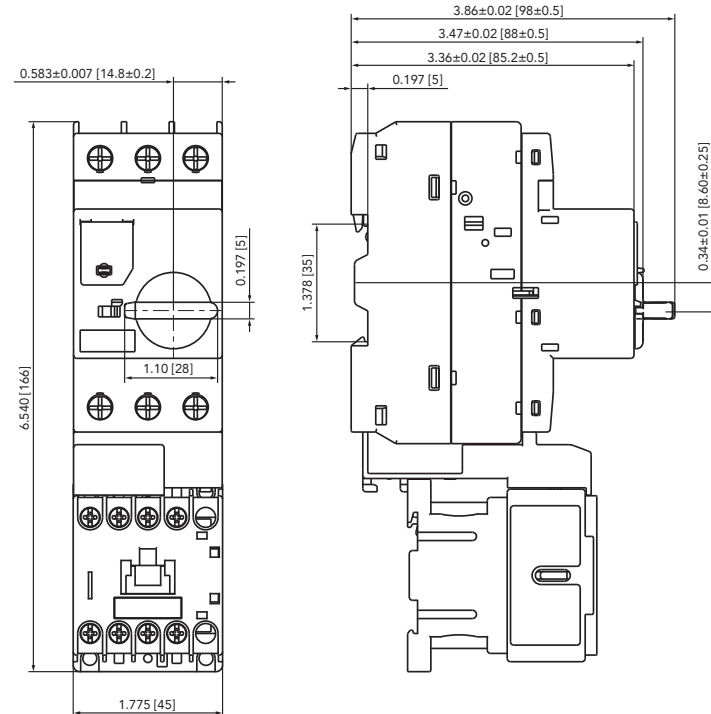

### CC51

Unit: in [mm]

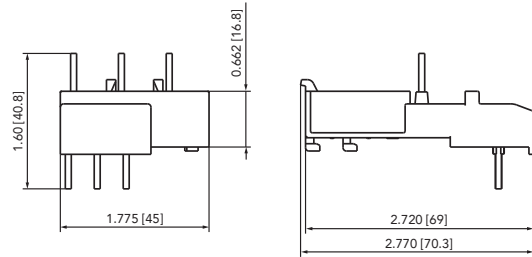

### Ex9S32 + CC52 + Ex9C09, 12 18

Unit: in [mm]

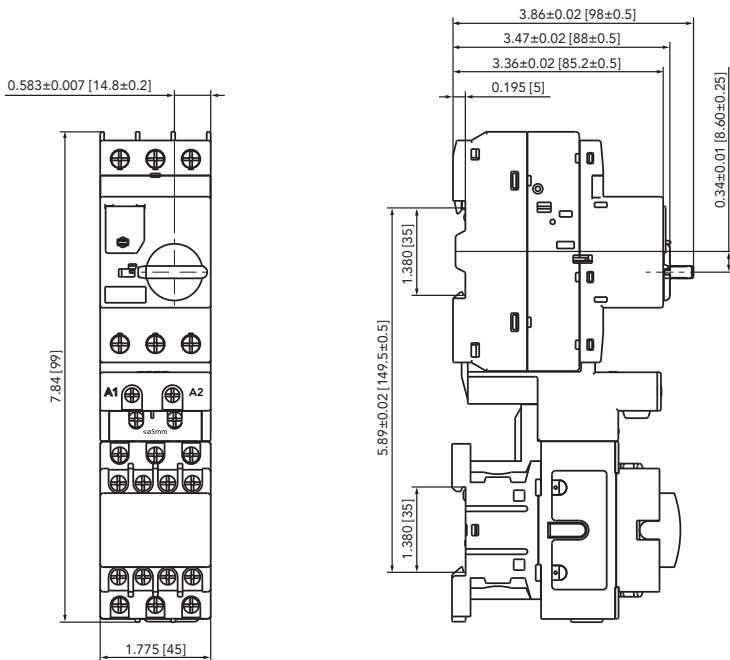

### CC52

Unit: in [mm]

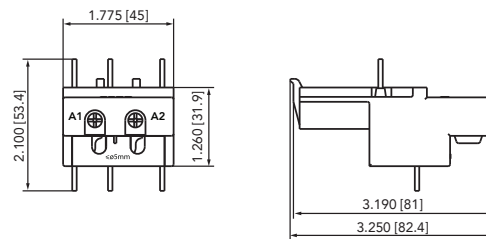

## Manual Motor Starter Ex9S32 Accessories: Dimensions

### Ex9S32 + CC52 + Ex9C09, 12, 18 + DRA51

Unit: in [mm]

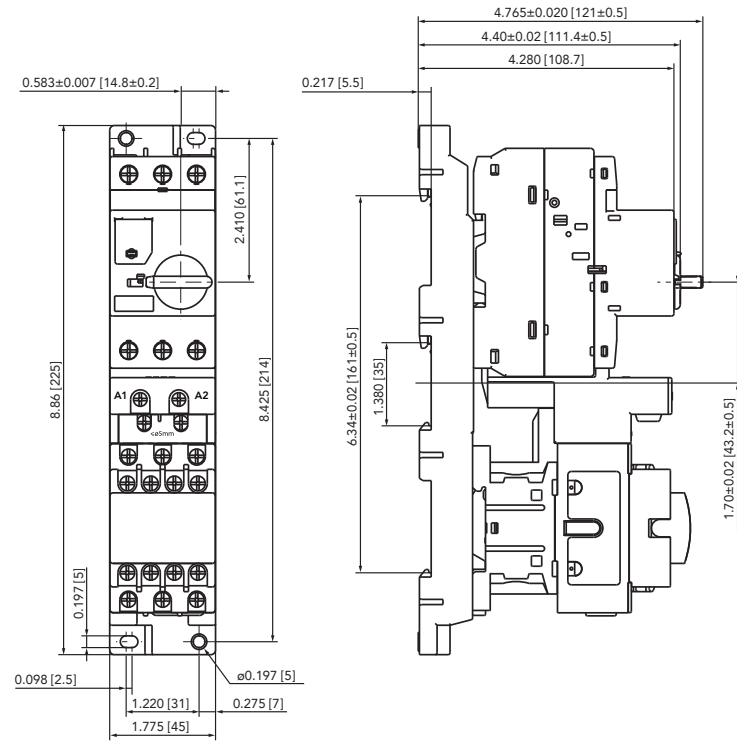

### CC52

Unit: in [mm]

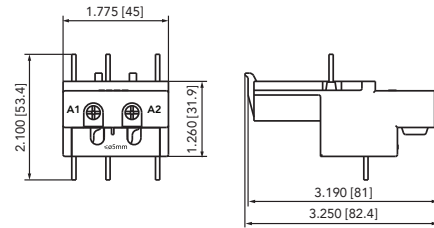

### DRA51

Unit: in [mm]

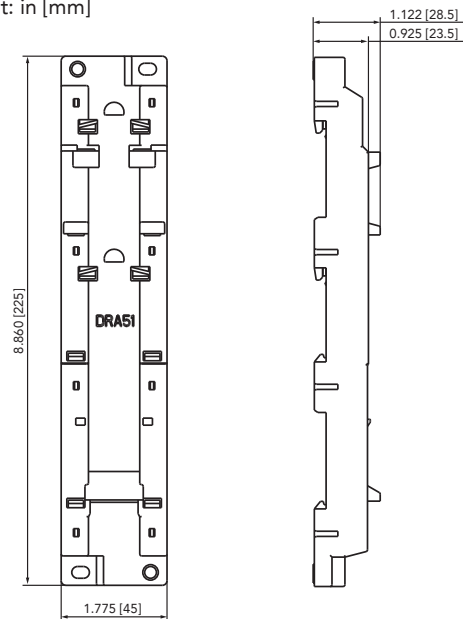

### Ex9S32 + CC53 + Ex9C25, 32, 38

Unit: in [mm]

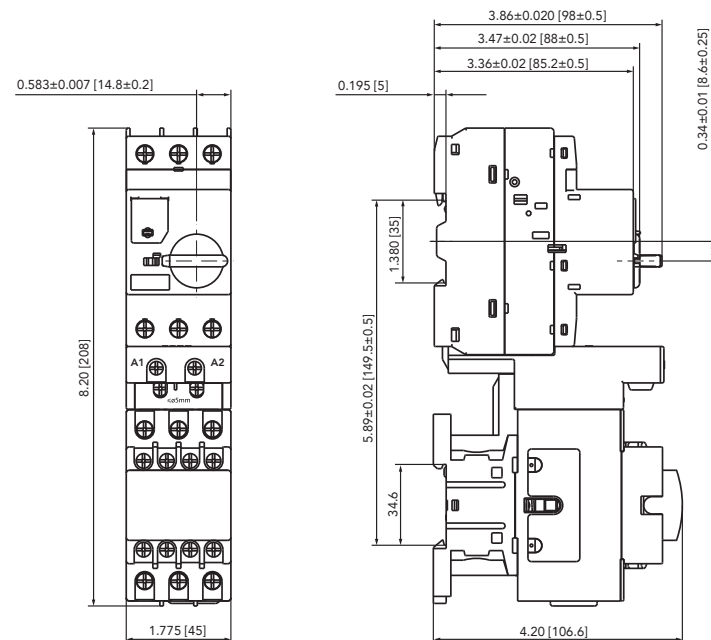

### CC53

Unit: in [mm]

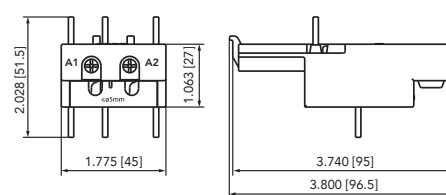

## Manual Motor Starter Ex9S32 Accessories: Dimensions

### Ex9S32 + CC53 + Ex9C25, 32, 38 + DRA51 Unit: in [mm]

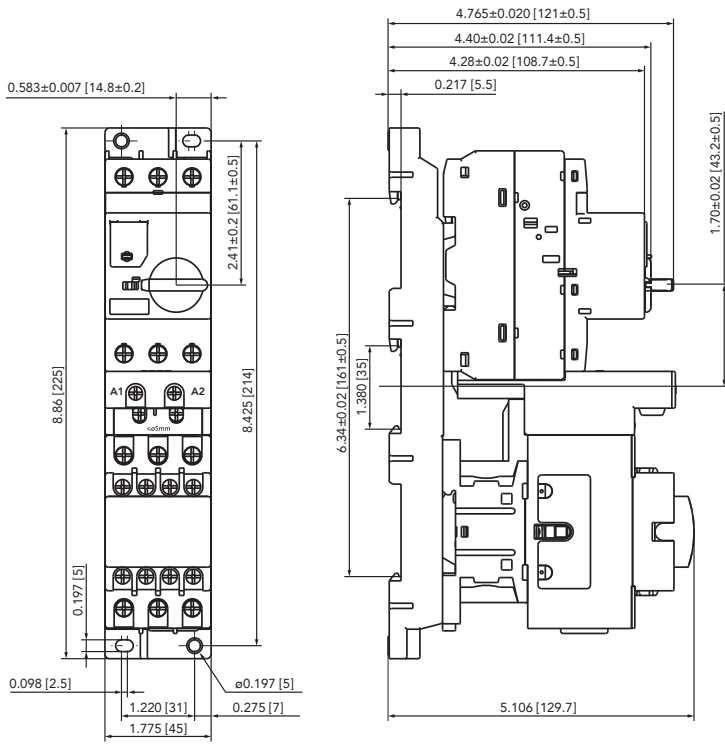

### CC53 Unit: in [mm]

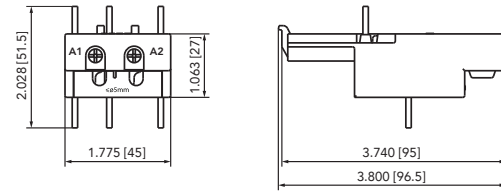

### DRA51 Unit: in [mm]

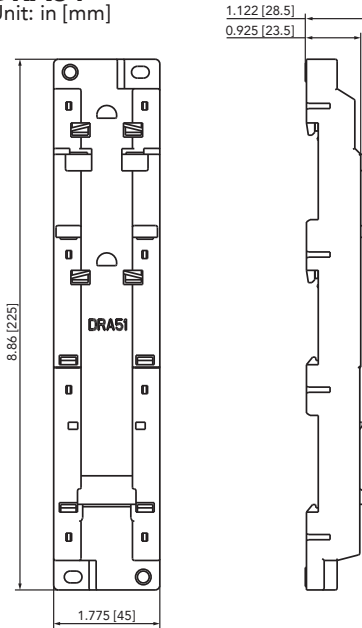

### ERH51 Unit: in [mm]

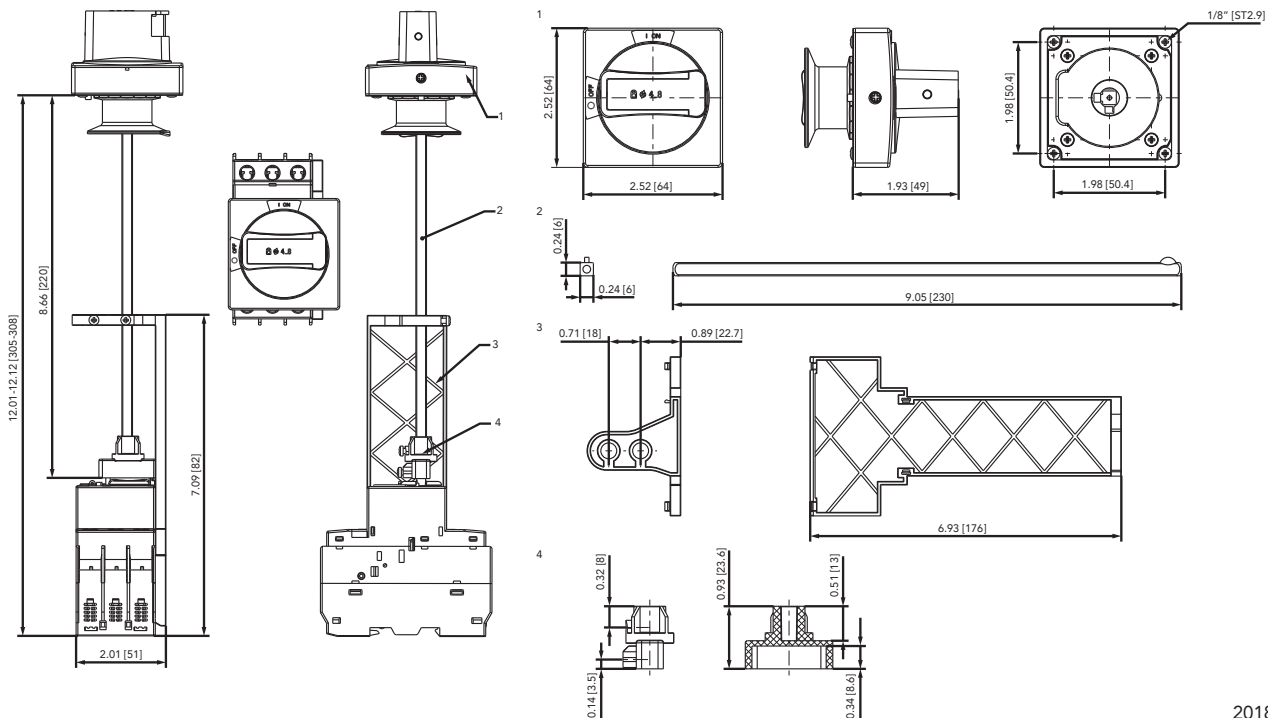

## Manual Motor Starter Ex9S32 Accessories: Dimensions

**WPB51**  
Unit: in [mm]

