

Ø 30 mm Selector Switches



S3SF Series PRODUCT MANUAL

For your safety, read and follow the considerations written in the instruction manual, other manuals and Autonics website.

The specifications, dimensions, etc. are subject to change without notice for product improvement. Some models may be discontinued without notice.

Features

- Smooth operation
- High electrical conductivity
- Long-lasting durability

Safety Considerations

- Observe all 'Safety Considerations' for safe and proper operation to avoid hazards.
- ⚠ symbol indicates caution due to special circumstances in which hazards may occur.



⚠ Warning Failure to follow instructions may result in serious injury or death.

- 01. Fail-safe device must be installed when using the unit with machinery that may cause serious injury or substantial economic loss. (e.g. nuclear power control, medical equipment, ships, vehicles, railways, aircraft, combustion apparatus, safety equipment, crime / disaster prevention devices, etc.)**
Failure to follow this instruction may result in personal injury, economic loss or fire.
- 02. Do not use or store the unit in the place where flammable / explosive / corrosive gas, high humidity, direct sunlight, radiant heat, vibration, impact, or salinity may be present.**
Failure to follow this instruction may result in explosion or fire.
- 03. Install on a device panel to use.**
Failure to follow this instruction may result in fire or electric shock.
- 04. Do not connect, repair, or inspect the unit while connected to a power source.**
Failure to follow this instruction may result in fire or electric shock.
- 05. Do not disassemble or modify the unit.**
Failure to follow this instruction may result in fire or electric shock.



⚠ Caution Failure to follow instructions may result in injury or product damage.

- 01. This unit shall not be used outdoors.**
Failure to follow this instruction may result in shortening the life cycle of the product or electric shock.
- 02. Use the unit within the rated specifications.**
Failure to follow this instruction may result in fire or product damage.
- 03. Do not use the load beyond rated switching capacity contact.**
Failure to follow this instruction may result in fire, relay broken, contact melt, insulation failure or contact failure.
- 04. For wiring the product, do not pull the wiring excessively or apply excessive force.**
Failure to follow this instruction may result in product damage or malfunction.
- 05. Use dry cloth to clean the unit, and do not use water or organic solvent.**
Failure to follow this instruction may result in fire or electric shock.
- 06. Keep the product away from metal chip, dust, and wire residue which from flowing into the unit.**
Failure to follow this instruction may result in fire or product damage.

Specifications

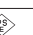
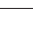
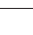
Series	S3SF Series
Actuation angle	2-position: [Spring return] $60^\circ \pm 5^\circ$, $90^\circ \pm 5^\circ$ [Maintained] $90^\circ \pm 5^\circ$ 3-position: [Spring return] $60^\circ \pm 5^\circ$, $45^\circ \pm 5^\circ$ [Maintained] $90^\circ \pm 5^\circ$, $45^\circ \pm 5^\circ$
Actuation force	0.5 kgf (4.9 N) (per 1 contact)
Installation	Flush
Shock	300 m/s ² (\approx 30 G) in each X, Y, Z direction for 3 times
Shock (malfunction)	100 m/s ² (\approx 10 G) in each X, Y, Z direction for 3 times
Vibration	1.5 mm double amplitude at frequency of 10 to 55 Hz in each X, Y, Z direction for 2 hours
Vibration (malfunction)	1.5 mm double amplitude at frequency of 10 to 55 Hz in each X, Y, Z direction for 10 minutes
Mechanical life cycle (control unit life cycle)	\geq 100,000 operations (20 operations/min)
Ambient temperature	-15 to 55 °C, storage: -25 to 65 °C (no freezing or condensation)
Ambient humidity	35 to 85 %RH, storage: 35 to 85 %RH (no freezing or condensation)
Protection structure	Control unit: IP52 (IEC standard)
Certification	CE UK cTUVus ENEC   
Control unit weight	Standard head type: \approx 23.5 g Shark-head type: \approx 21 g
Housing weight	\approx 7 g

Contact blocks	
Power supply / current	110 VAC~ / 10 A, 250 VAC~ / 6 A
Dielectric strength	Between the charging part and the case : 3,000 VAC~ 50/60 Hz for 1 minute
Insulation resistance	\geq 1,000 M Ω (500 VDC= megger)
Contact resistance	\leq 20 m Ω (initial)
Electrical life cycle	\geq 100,000 operations (20 operations/min)
Contact material	AgNi10
Certification	CE UK cTUVus ENEC   
Weight	Modular type: \approx 10 g, Singular type: \approx 11 g

LED blocks	
Rated voltage	AC/DC voltage type: 12-24 VAC~ 50/60 Hz, 12-24 VDC= AC voltage type: 110-220 VAC~ 50/60 Hz
Current consumption	\leq 20 mA
Certification	CE UK cTUVus ENEC   
Weight	AC/DC voltage type: \approx 11 g, AC voltage type: \approx 12 g

Sold Separately

- Contact blocks (SA□-C□□)
- LED blocks (SA□-L□□□)
- Locking handle (SA□-LH)
- Switch washer (SA-SW□)

Assembly / Disassembly

- Assembly order: ①→②→③→④
- Disassembly order: ④→③→②→①

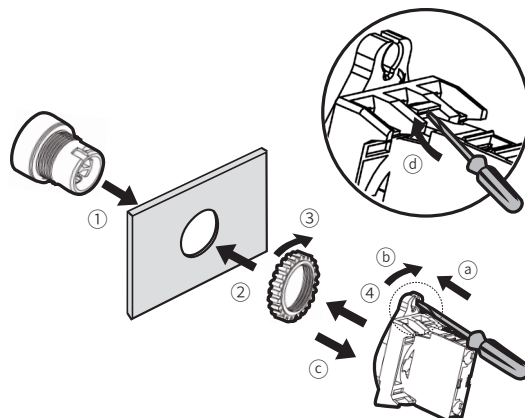

Control Switches	Panel thickness	Tightening torque
Ø 22/25/30 mm	Max. 6 mm	\leq 1.96 N·m

Actuation angle

■ 2-position spring return (standard lever)

No mark

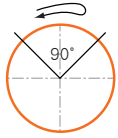

Left 45° - Right 45°

■ 2-position maintained (standard lever)

No mark

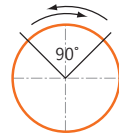

Left 45° - Right 45°

■ 2-position spring return (shark-head lever)

No mark

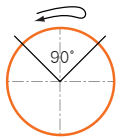

Left 45° - Right 45°

A

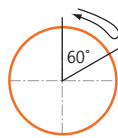

Center 0° - Right 60°

B

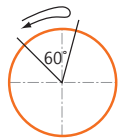

Left 45° - Right 15°

■ 2-position maintained (shark-head lever)

A

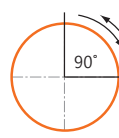

Center 0° - Right 90°

B

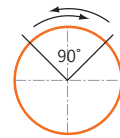

Left 45° - Right 45°

■ 3-position two-way spring return

No mark

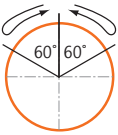

Left 60° - Right 60°

K

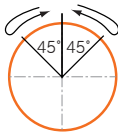

Left 45° - Right 45°

■ 3-position maintained

No mark

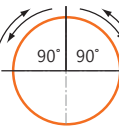

Left 90° - Right 90°

K



Left 45° - Right 45°

■ 3-position right spring return

No mark

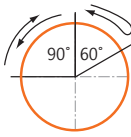

Left 90° - Right 60°

K



Left 45° - Right 45°

■ 3-position left spring return

No mark

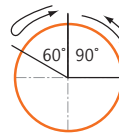

Left 60° - Right 90°

K

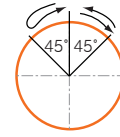

Left 45° - Right 45°

Ordering Information

This is only for reference. For selecting the specified model, follow the Autonics website.

Model is based on control unit+block combination. Control units or blocks are sold separately. In case of block, refer to control switch accessories.

■ Non-illuminated

S3	①	②	-	③	④	⑤	⑥	⑦	⑧
Control unit								Block	

① Switch type

SF: Round selector switch (flush)

② Appearance

No mark: Standard lever

N: Shark-head lever

③ Illuminated

S: Non-illuminated

④ Operation

Short lever	Long lever	Operation
1	2	2-position spring return
3	4	2-position maintained
5	6	3-position two-way spring return
7	8	3-position maintained
A	B	3-position right spring return
C	D	3-position left spring return

⑤ Actuation angle

Refer to Actuation Angle.

⑥ Color

R: Red

W: White

⑦ Contact block

A: 1 A contact

2A: 2 A contacts

B: 1 B contact

2B: 2 B contacts

AB: 1 A contact, 1 B contact

⑧ Block type

No mark: Singular type

M: Modular type

Model	Contact block		LED block	
	A contact	B contact	AC/DC voltage	AC voltage
S3SF-S1□A(M)	1	-	-	-
S3SF-S1□2A(M)	2	-	-	-
S3SF-S1□B(M)	-	1	-	-
S3SF-S1□2B(M)	-	2	-	-
S3SF-S1□AB(M)	1	1	-	-
S3SF-S3□A(M)	1	-	-	-
S3SF-S3□2A(M)	2	-	-	-
S3SF-S3□B(M)	-	1	-	-
S3SF-S3□2B(M)	-	2	-	-
S3SF-S3□AB(M)	1	1	-	-
S3SF-S5K□2A(M)	2	-	-	-
S3SF-S5K□2B(M)	-	2	-	-
S3SF-S5K□AB(M)	1	1	-	-
S3SF-S7K□2A(M)	2	-	-	-
S3SF-S7K□2B(M)	-	2	-	-
S3SF-S7K□AB(M)	1	1	-	-
S3SF-SAK□2A(M)	2	-	-	-
S3SF-SAK□2B(M)	-	2	-	-
S3SF-SAK□AB(M)	1	1	-	-
S3SF-SCK□2A(M)	2	-	-	-
S3SF-SCK□2B(M)	-	2	-	-
S3SF-SCK□AB(M)	1	1	-	-
S3SF-S5□2A(M)	2	-	-	-
S3SF-S5□2B(M)	-	2	-	-
S3SF-S5□AB(M)	1	1	-	-
S3SF-S7□2A(M)	2	-	-	-
S3SF-S7□2B(M)	-	2	-	-
S3SF-S7□AB(M)	1	1	-	-
S3SF-SA□2A(M)	2	-	-	-
S3SF-SA□2B(M)	-	2	-	-
S3SF-SA□AB(M)	1	1	-	-
S3SF-SC□2A(M)	2	-	-	-
S3SF-SC□2B(M)	-	2	-	-
S3SF-SC□AB(M)	1	1	-	-
S3SF-S2□A(M)	1	-	-	-
S3SF-S2□2A(M)	2	-	-	-
S3SF-S2□B(M)	-	1	-	-
S3SF-S2□2B(M)	-	2	-	-
S3SF-S2□AB(M)	1	1	-	-
S3SF-S4□A(M)	1	-	-	-
S3SF-S4□2A(M)	2	-	-	-
S3SF-S4□B(M)	-	1	-	-
S3SF-S4□2B(M)	-	2	-	-
S3SF-S4□AB(M)	1	1	-	-
S3SF-S6K□2A(M)	2	-	-	-
S3SF-S6K□2B(M)	-	2	-	-
S3SF-S6K□AB(M)	1	1	-	-
S3SF-S8K□2A(M)	2	-	-	-
S3SF-S8K□2B(M)	-	2	-	-
S3SF-S8K□AB(M)	1	1	-	-
S3SF-SBK□2A(M)	2	-	-	-
S3SF-SBK□2B(M)	-	2	-	-
S3SF-SBK□AB(M)	1	1	-	-
S3SF-SDK□2A(M)	2	-	-	-
S3SF-SDK□2B(M)	-	2	-	-
S3SF-SDK□AB(M)	1	1	-	-
S3SF-S6□2A(M)	2	-	-	-
S3SF-S6□2B(M)	-	2	-	-
S3SF-S6□2AB(M)	1	1	-	-
S3SF-S8□2A(M)	2	-	-	-
S3SF-S8□2B(M)	-	2	-	-
S3SF-S8□AB(M)	1	1	-	-
S3SF-SB□2A(M)	2	-	-	-
S3SF-SB□2B(M)	-	2	-	-
S3SF-SB□AB(M)	1	1	-	-
S3SF-SD□2A(M)	2	-	-	-
S3SF-SD□2B(M)	-	2	-	-
S3SF-SD□AB(M)	1	1	-	-

Model	Contact block		LED block	
	A contact	B contact	AC/DC voltage	AC voltage
S3SFN-S1A□A(M)	1	-	-	-
S3SFN-S1A□2A(M)	2	-		
S3SFN-S1A□B(M)	-	1		
S3SFN-S1A□2B(M)	-	2		
S3SFN-S1A□AB(M)	1	1	-	-
S3SFN-S3A□A(M)	1	-		
S3SFN-S3A□2A(M)	2	-		
S3SFN-S3A□B(M)	-	1		
S3SFN-S3A□2B(M)	-	2		
S3SFN-S3A□AB(M)	1	1		
S3SFN-S1B□A(M)	1	-		
S3SFN-S1B□2A(M)	2	-		
S3SFN-S1B□B(M)	-	1		
S3SFN-S1B□2B(M)	-	2		
S3SFN-S1B□AB(M)	1	1	-	-
S3SFN-S3B□A(M)	1	-		
S3SFN-S3B□2A(M)	2	-		
S3SFN-S3B□B(M)	-	1		
S3SFN-S3B□2B(M)	-	2		
S3SFN-S3B□AB(M)	1	1		
S3SFN-S1□A(M)	1	-		
S3SFN-S1□2A(M)	2	-		
S3SFN-S1□B(M)	-	1		
S3SFN-S1□2B(M)	-	2		
S3SFN-S1□AB(M)	1	1	-	-
S3SFN-S5K□2A(M)	2	-		
S3SFN-S5K□2B(M)	-	2		
S3SFN-S5K□AB(M)	1	1		
S3SFN-S7K□2A(M)	2	-		
S3SFN-S7K□2B(M)	-	2		
S3SFN-S7K□AB(M)	1	1		
S3SFN-SAK□2A(M)	2	-		
S2SFN-SAK□2B(M)	-	2		
S2SFN-SAK□AB(M)	1	1		
S2SFN-SCK□2A(M)	2	-		
S2SFN-SCK□2B(M)	-	2		
S2SFN-SCK□AB(M)	1	1		
S3SFN-S5□2A(M)	2	-		
S3SFN-S5□2B(M)	-	2		
S3SFN-S5□AB(M)	1	1		
S3SFN-S7□2A(M)	2	-		
S3SFN-S7□2B(M)	-	2		
S3SFN-S7□AB(M)	1	1	-	-
S3SFN-SA□2A(M)	2	-		
S2SFN-SA□2B(M)	-	2		
S2SFN-SA□AB(M)	1	1		
S2SFN-SC□2A(M)	2	-		
S2SFN-SC□2B(M)	-	2		
S2SFN-SC□AB(M)	1	1		
S3SFN-S2A□A(M)	1	-		
S3SFN-S2A□2A(M)	2	-		
S3SFN-S2A□B(M)	-	1		
S3SFN-S2A□2B(M)	-	2		
S3SFN-S2A□AB(M)	1	1	-	-
S3SFN-S4A□A(M)	1	-		
S3SFN-S4A□2A(M)	2	-		
S3SFN-S4A□B(M)	-	1		
S3SFN-S4A□2B(M)	-	2		
S3SFN-S4A□AB(M)	1	1		
S3SFN-S2B□A(M)	1	-		
S3SFN-S2B□2A(M)	2	-		
S3SFN-S2B□B(M)	-	1		
S3SFN-S2B□2B(M)	-	2		
S3SFN-S2B□AB(M)	1	1	-	-
S3SFN-S4B□A(M)	1	-		
S3SFN-S4B□2A(M)	2	-		
S3SFN-S4B□B(M)	-	1		
S3SFN-S4B□2B(M)	-	2		
S3SFN-S4B□AB(M)	1	1		
S3SFN-S2□A(M)	1	-		
S3SFN-S2□2A(M)	2	-		
S3SFN-S2□B(M)	-	1		
S3SFN-S2□2B(M)	-	2		
S3SFN-S2□AB(M)	1	1		

Model	Contact block		LED block	
	A contact	B contact	AC/DC voltage	AC voltage
S3SFN-S6K□2A(M)	2	-	-	-
S3SFN-S6K□2B(M)	-	2		
S3SFN-S6K□AB(M)	1	1		
S3SFN-S8K□2A(M)	2	-	-	-
S3SFN-S8K□2B(M)	-	2		
S3SFN-S8K□AB(M)	1	1		
S3SFN-SBK□2A(M)	2	-		
S3SFN-SBK□2B(M)	-	2	-	-
S3SFN-SBK□AB(M)	1	1		
S3SFN-SDK□2A(M)	2	-		
S3SFN-SDK□2B(M)	-	2		
S3SFN-SDK□AB(M)	1	1	-	-
S3SFN-S6□2A(M)	2	-		
S3SFN-S6□2B(M)	-	2		
S3SFN-S6□AB(M)	1	1		
S3SFN-S8□2A(M)	2	-	-	-
S3SFN-S8□2B(M)	-	2		
S3SFN-S8□AB(M)	1	1		
S3SFN-S8□AB(M)	1	1	-	-
S3SFN-SB□2A(M)	2	-		
S3SFN-SB□2B(M)	-	2		
S3SFN-SB□AB(M)	1	1		
S3SFN-SD□2A(M)	2	-	-	-
S3SFN-SD□2B(M)	-	2		
S3SFN-SD□AB(M)	1	1		

■ Illuminated

S3	1	2	-	3	4	5	6	7	8	9
Control unit								Block		

1 Switch type

SF: Round selector switch (flush)

2 Appearance

N: Shark-head lever

3 Illuminated

L: Illuminated

4 Operation

Short lever	Long lever	Operation
1	2	2-position spring return
3	4	2-position maintained
5	6	3-position two-way spring return
7	8	3-position maintained
A	B	3-position right spring return
C	D	3-position left spring return

5 Actuation angle

Refer to Actuation Angle.

6 Color

R: Red
B: Blue
G: Green
Y: Yellow

7 Contact block

A: 1 A contact
2A: 2 A contacts
B: 1 B contact
2B: 2 B contacts
AB: 1 A contact, 1 B contact

8 LED block

D: 1 AC/DC voltage type
L: 1 AC voltage type

9 Block type

No mark: Singular type
M: Modular type

Model	Contact block		LED block	
	A contact	B contact	AC/DC voltage	AC voltage
S3SFN-L1A□AL(M)	1	-	-	-
S3SFN-L1A□2AL(M)	2	-	-	-
S3SFN-L1A□BL(M)	-	1	-	1
S3SFN-L1A□2BL(M)	-	2	-	-
S3SFN-L1A□ABL(M)	1	1	-	-
S3SFN-L3A□AL(M)	1	-	-	-
S3SFN-L3A□2AL(M)	2	-	-	-
S3SFN-L3A□BL(M)	-	1	-	1
S3SFN-L3A□2BL(M)	-	2	-	-
S3SFN-L3A□ABL(M)	1	1	-	-
S3SFN-L1B□AL(M)	1	-	-	-
S3SFN-L1B□2AL(M)	2	-	-	-
S3SFN-L1B□BL(M)	-	1	-	1
S3SFN-L1B□2BL(M)	-	2	-	-
S3SFN-L1B□ABL(M)	1	1	-	-
S3SFN-L3B□AL(M)	1	-	-	-
S3SFN-L3B□2AL(M)	2	-	-	-
S3SFN-L3B□BL(M)	-	1	-	1
S3SFN-L3B□2BL(M)	-	2	-	-
S3SFN-L3B□ABL(M)	1	1	-	-
S3SFN-L1□AL(M)	1	-	-	-
S3SFN-L1□2AL(M)	2	-	-	-
S3SFN-L1□BL(M)	-	1	-	1
S3SFN-L1□2BL(M)	-	2	-	-
S3SFN-L1□ABL(M)	1	1	-	-
S3SFN-L5K□2AL(M)	2	-	-	-
S3SFN-L5K□2BL(M)	-	2	-	1
S3SFN-L5K□ABL(M)	1	1	-	-
S3SFN-L7K□2AL(M)	2	-	-	-
S3SFN-L7K□2BL(M)	-	2	-	1
S3SFN-L7K□ABL(M)	1	1	-	-
S3SFN-LAK□2AL(M)	2	-	-	-
S3SFN-LAK□2BL(M)	-	2	-	1
S3SFN-LAK□ABL(M)	1	1	-	-
S3SFN-LCK□2AL(M)	2	-	-	-
S3SFN-LCK□2BL(M)	-	2	-	1
S3SFN-LCK□ABL(M)	1	1	-	-
S3SFN-L5□2AL(M)	2	-	-	-
S3SFN-L5□2BL(M)	-	2	-	1
S3SFN-L5□ABL(M)	1	1	-	-
S3SFN-L7□2AL(M)	2	-	-	-
S3SFN-L7□2BL(M)	-	2	-	1
S3SFN-L7□ABL(M)	1	1	-	-
S3SFN-LA□2AL(M)	2	-	-	-
S3SFN-LA□2BL(M)	-	2	-	1
S3SFN-LA□ABL(M)	1	1	-	-
S3SFN-LC□2AL(M)	2	-	-	-
S3SFN-LC□2BL(M)	-	2	-	1
S3SFN-LC□ABL(M)	1	1	-	-
S3SFN-L1A□AD(M)	1	-	1	-
S3SFN-L1A□2AD(M)	2	-	-	-
S3SFN-L1A□BD(M)	-	1	-	-
S3SFN-L1A□2BD(M)	-	2	-	-
S3SFN-L1A□ABD(M)	1	1	-	-
S3SFN-L3A□AD(M)	1	-	1	-
S3SFN-L3A□2AD(M)	2	-	-	-
S3SFN-L3A□BD(M)	-	1	-	-
S3SFN-L3A□2BD(M)	-	2	-	-
S3SFN-L3A□ABD(M)	1	1	-	-
S3SFN-L1B□AD(M)	1	-	1	-
S3SFN-L1B□2AD(M)	2	-	-	-
S3SFN-L1B□BD(M)	-	1	-	-
S3SFN-L1B□2BD(M)	-	2	-	-
S3SFN-L1B□ABD(M)	1	1	-	-
S3SFN-L3B□AD(M)	1	-	1	-
S3SFN-L3B□2AD(M)	2	-	-	-
S3SFN-L3B□BD(M)	-	1	-	-
S3SFN-L3B□2BD(M)	-	2	-	-
S3SFN-L3B□ABD(M)	1	1	-	-

Model	Contact block		LED block	
	A contact	B contact	AC/DC voltage	AC voltage
S3SFN-L1□AD(M)	1	-	1	-
S3SFN-L1□2AD(M)	2	-		
S3SFN-L1□BD(M)	-	1		
S3SFN-L1□2BD(M)	-	2		
S3SFN-L1□ABD(M)	1	1		
S3SFN-L5K□2AD(M)	2	-	1	-
S3SFN-L5K□2BD(M)	-	2		
S3SFN-L5K□ABD(M)	1	1		
S3SFN-L7K□2AD(M)	2	-	1	-
S3SFN-L7K□2BD(M)	-	2		
S3SFN-L7K□ABD(M)	1	1		
S3SFN-LAK□2AD(M)	2	-	1	-
S3SFN-LAK□2BD(M)	-	2		
S3SFN-LAK□ABD(M)	1	1		
S3SFN-LCK□2AD(M)	2	-	1	-
S3SFN-LCK□2BD(M)	-	2		
S3SFN-LCK□ABD(M)	1	1		
S3SFN-L5□2AD(M)	2	-	1	-
S3SFN-L5□2BD(M)	-	2		
S3SFN-L5□ABD(M)	1	1		
S3SFN-L7□2AD(M)	2	-	1	-
S3SFN-L7□2BD(M)	-	2		
S3SFN-L7□ABD(M)	1	1		
S3SFN-LA□2AD(M)	2	-	1	-
S3SFN-LA□2BD(M)	-	2		
S3SFN-LA□ABD(M)	1	1		
S3SFN-LC□2AD(M)	2	-	1	-
S3SFN-LC□2BD(M)	-	2		
S3SFN-LC□ABD(M)	1	1		
S3SFN-L2A□AL(M)	1	-	-	1
S3SFN-L2A□2AL(M)	2	-		
S3SFN-L2A□BL(M)	-	1		
S3SFN-L2A□2BL(M)	-	2		
S3SFN-L2A□ABL(M)	1	1		
S3SFN-L4A□AL(M)	1	-	-	1
S3SFN-L4A□2AL(M)	2	-		
S3SFN-L4A□BL(M)	-	1		
S3SFN-L4A□2BL(M)	-	2		
S3SFN-L4A□ABL(M)	1	1		
S3SFN-L2B□AL(M)	1	-	-	1
S3SFN-L2B□2AL(M)	2	-		
S3SFN-L2B□BL(M)	-	1		
S3SFN-L2B□2BL(M)	-	2		
S3SFN-L2B□ABL(M)	1	1		
S3SFN-L4B□AL(M)	1	-	-	1
S3SFN-L4B□2AL(M)	2	-		
S3SFN-L4B□BL(M)	-	1		
S3SFN-L4B□2BL(M)	-	2		
S3SFN-L4B□ABL(M)	1	1		
S3SFN-L2□AL(M)	1	-	-	1
S3SFN-L2□2AL(M)	2	-		
S3SFN-L2□BL(M)	-	1		
S3SFN-L2□2BL(M)	-	2		
S3SFN-L2□ABL(M)	1	1		
S3SFN-L6K□2AL(M)	2	-	-	1
S3SFN-L6K□2BL(M)	-	2		
S3SFN-L6K□ABL(M)	1	1		
S3SFN-L8K□2AL(M)	2	-	-	1
S3SFN-L8K□2BL(M)	-	2		
S3SFN-L8K□ABL(M)	1	1		
S3SFN-LBK□2AL(M)	2	-	-	1
S3SFN-LBK□2BL(M)	-	2		
S3SFN-LBK□ABL(M)	1	1		
S3SFN-LDK□2AL(M)	2	-	-	1
S3SFN-LDK□2BL(M)	-	2		
S3SFN-LDK□ABL(M)	1	1		
S3SFN-L6□2AL(M)	2	-	-	1
S3SFN-L6□2BL(M)	-	2		
S3SFN-L6□ABL(M)	1	1		
S3SFN-L8□2AL(M)	2	-	-	1
S3SFN-L8□2BL(M)	-	2		
S3SFN-L8□ABL(M)	1	1		

Model	Contact block		LED block	
	A contact	B contact	AC/DC voltage	AC voltage
S3SFN-LB□2AL(M)	2	-	-	1
S3SFN-LB□2BL(M)	-	2		
S3SFN-LB□ABL(M)	1	1		
S3SFN-LD□2AL(M)	2	-	-	1
S3SFN-LD□2BL(M)	-	2		
S3SFN-LD□ABL(M)	1	1		
S3SFN-L2A□AD(M)	1	-	1	-
S3SFN-L2A□2AD(M)	2	-		
S3SFN-L2A□BD(M)	-	1		
S3SFN-L2A□2BD(M)	-	2		
S3SFN-L2A□ABD(M)	1	1		
S3SFN-L4A□AD(M)	1	-	1	-
S3SFN-L4A□2AD(M)	2	-		
S3SFN-L4A□BD(M)	-	1		
S3SFN-L4A□2BD(M)	-	2		
S3SFN-L4A□ABD(M)	1	1		
S3SFN-L2B□AD(M)	1	-	1	-
S3SFN-L2B□2AD(M)	2	-		
S3SFN-L2B□BD(M)	-	1		
S3SFN-L2B□2BD(M)	-	2		
S3SFN-L2B□ABD(M)	1	1		
S3SFN-L4B□AD(M)	1	-	1	-
S3SFN-L4B□2AD(M)	2	-		
S3SFN-L4B□BD(M)	-	1		
S3SFN-L4B□2BD(M)	-	2		
S3SFN-L4B□ABD(M)	1	1		
S3SFN-L2□AD(M)	1	-	1	-
S3SFN-L2□2AD(M)	2	-		
S3SFN-L2□BD(M)	-	1		
S3SFN-L2□2BD(M)	-	2		
S3SFN-L2□ABD(M)	1	1		
S3SFN-L6K□2AD(M)	2	-	1	-
S3SFN-L6K□2BD(M)	-	2		
S3SFN-L6K□ABD(M)	1	1		
S3SFN-L8K□2AD(M)	2	-	1	-
S3SFN-L8K□2BD(M)	-	2		
S3SFN-L8K□ABD(M)	1	1		
S3SFN-LBK□2AD(M)	2	-	1	-
S3SFN-LBK□2BD(M)	-	2		
S3SFN-LBK□ABD(M)	1	1		
S3SFN-LDK□2AD(M)	2	-	1	-
S3SFN-LDK□2BD(M)	-	2		
S3SFN-LDK□ABD(M)	1	1		
S3SFN-L6□2AD(M)	2	-	1	-
S3SFN-L6□2BD(M)	-	2		
S3SFN-L6□ABD(M)	1	1		
S3SFN-L8□2AD(M)	2	-	1	-
S3SFN-L8□2BD(M)	-	2		
S3SFN-L8□ABD(M)	1	1		
S3SFN-LB□2AD(M)	2	-	1	-
S3SFN-LB□2BD(M)	-	2		
S3SFN-LB□ABD(M)	1	1		
S3SFN-LD□2AD(M)	2	-	1	-
S3SFN-LD□2BD(M)	-	2		
S3SFN-LD□ABD(M)	1	1		

Dimensions

- Unit: mm, For the detailed drawings, follow the Autonics website.
- Panel thickness: ≤ 6 mm

■ S3SF-S1/3/5/7/A/C □ (standard / short lever, singular type block)

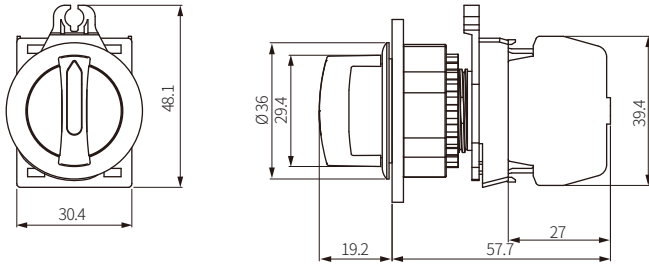

■ S3SF-S1/3/5/7/A/C □ M (standard / short lever, modular type block)

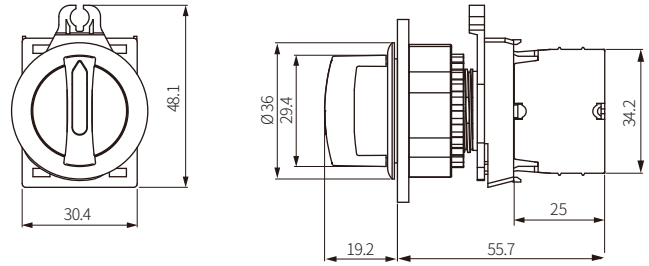

■ S3SF-S2/4/6/8/B/D □ (standard / long lever, singular type block)

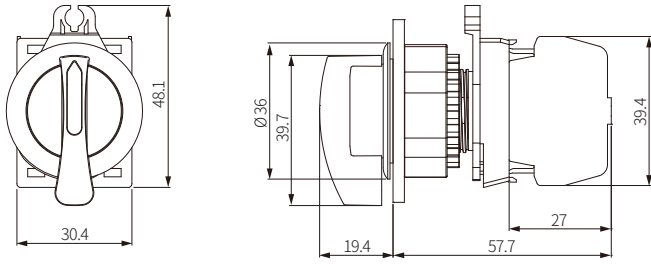

■ S3SF-S2/4/6/8/B/D □ M (standard / long lever, modular type block)

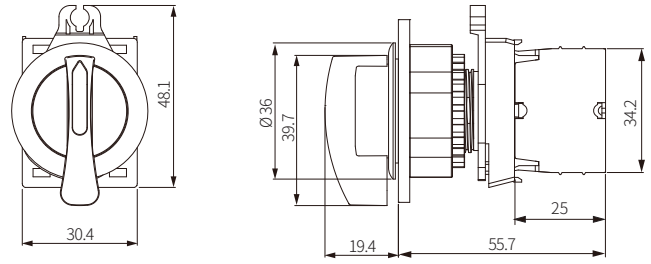

■ S3SFN-□1/3/5/7/A/C □ (shark-head / short lever, singular type block)

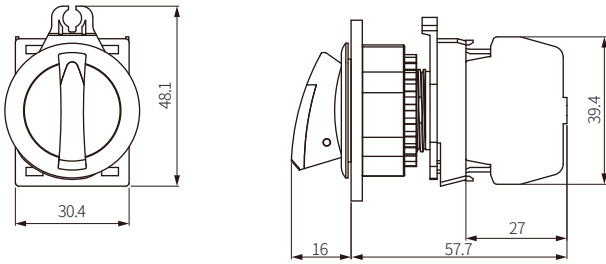

■ S3SFN-□1/3/5/7/A/C □ M (shark-head / short lever, modular type block)

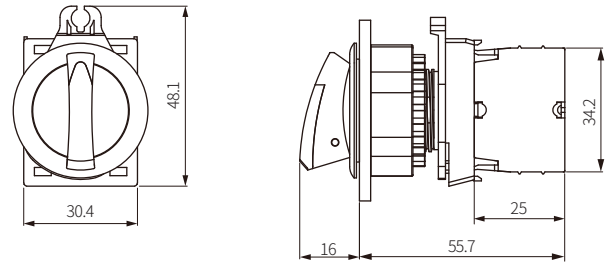

■ S3SFN-□2/4/6/8/B/D □ (shark-head / long lever, singular type block)

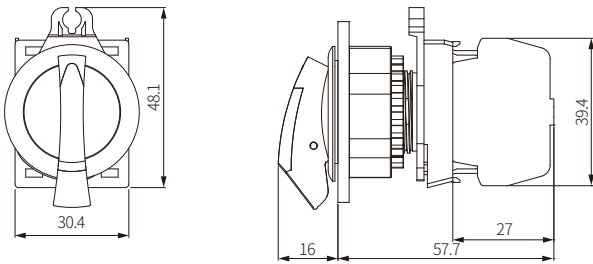

■ S3SFN-□2/4/6/8/B/D □ M (shark-head / long lever, modular type block)

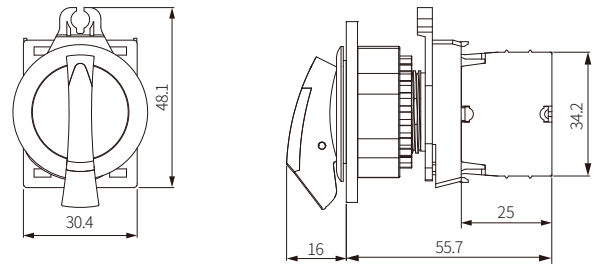



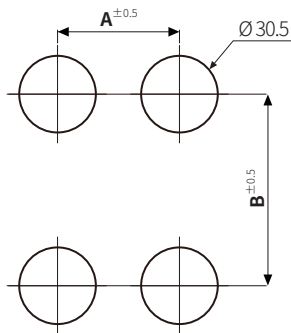

■ Panel cut-out



	A	B
Short lever	≥ 37	≥ 55
Long lever	≥ 55	≥ 55

Ø 22/25 mm, Ø 30 mm, □ 30 mm Control Switches Accessories

Contact Blocks (SA□ -C□ □)

Model	Contact	Features	Applied switches	Appearance
SA-CAM	A contact (normally open)	<ul style="list-style-type: none"> Modular type Ring / Fork terminal available Modular connection (up to 3 units) 	Ø 22/25 mm, Ø 30 mm, □ 30 mm Control switches	
SA-CBM	B contact (normally closed)			
SA-CA	A contact (normally open)	<ul style="list-style-type: none"> Singular type (dust-resistant contact point) Fork terminal available Loose screw prevention 		
SA-CB	B contact (normally closed)			





Power supply / current	110 VAC~ / 10 A, 250 VAC~ / 6 A
Dielectric strength	Between the charging part and the case : 3,000 VAC~ 50/60 Hz for 1 minute
Insulation resistance	≥ 1,000 MΩ (500 VDC≡ megger)
Contact resistance	≤ 20 mΩ (initial)
Electrical life cycle	≥ 100,000 operations (20 operations/min)
Contact material	AgNi10
Certification	CE UK cTUVus ENEC
Weight	Modular type: ≈ 10 g, Singular type: ≈ 11 g

■ Removal

Separate the unit using a flat-head (-) screwdriver.



LED Blocks (SA□ -L□ □)

Model	Power supply	Features	Applied switches	Appearance
SA-LD□ M	AC/DC voltage type 12-24 VAC~ 50/60 Hz 12-24 VDC≡	<ul style="list-style-type: none"> Modular type Ring / Fork terminal available Modular connection (up to 3 units) 	Ø 22/25 mm, Ø 30 mm, □ 30 mm Control switches, Pilot lights	
SA-LA□ M	AC voltage type 110-220 VAC~ 50/60 Hz			
SA-LD□	AC/DC voltage type 12-24 VAC~ 50/60 Hz 12-24 VDC≡	<ul style="list-style-type: none"> Singular type (dust-resistant contact point) Fork terminal available Loose screw prevention 		
SA-LA□	AC voltage type 110-220 VAC~ 50/60 Hz			

□ : Color (R: Red / B: Blue / G: Green / Y: Yellow / W: White)

Rated voltage	AC/DC voltage type: 12-24 VAC~ 50/60 Hz, 12-24 VDC≡ AC voltage type: 110-220 VAC~ 50/60 Hz
Current consumption	≤ 20 mA
Certification	CE UK cTUVus ENEC
Weight	AC/DC voltage type: ≈ 11 g, AC voltage type: ≈ 12 g

■ Removal

Separate the unit using a flat-head (-) screwdriver. Same as contact removal method.

Locking Handle (SA□ -LH)





- For locking switch nuts behind the panels.

Model	Applied switches	Appearance
SA-LH	Ø 22/25 mm, Ø 30 mm, □ 30 mm Control switches, Pilot lights ⁰¹⁾	

01) Except Ø 30 mm round pressure switches (extended).

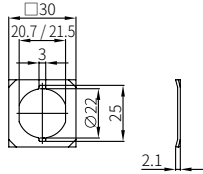
Switch Washer (SA-SW□)

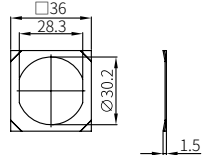
- The washer helps to improve switch tightening force.
- Unit: mm, For the detailed drawings, follow the Autonics web site.

Model	Applied switches	Dimensions	Appearance
SA-SW2	Ø 22/25 mm Control switches, Pilot lights		
SA-SW3	Ø 30 mm Control switches, Pilot lights		

Switch Enclosures (SA-□ B□)

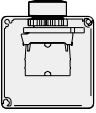
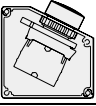
Model	Certification	Shape	Applied switches	Appearance
SA-SB□	CE	Square	Ø 22/25 mm Control switches	
SA-TB□	CE	Triangle		

□ : Number of holes (1 to 5)

• You can order the other size and the number of holes.

■ Dimensions

• Unit: mm, For the detailed drawings, follow the Autonics web site.

Model	Holes	L
SA-□ B1	1	86
SA-□ B2	2	136
SA-□ B3	3	186
SA-□ B4	4	236
SA-□ B5	5	286

• SA-SB□

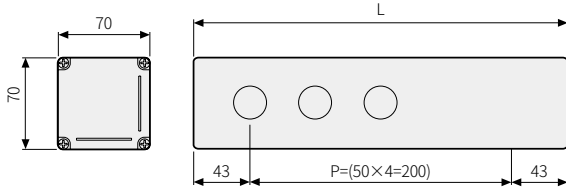



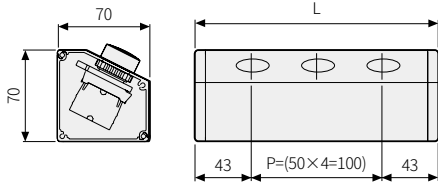

• SA-TB□

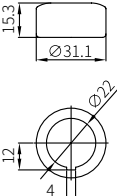

Switch Waterproof Cap (SA-W□)

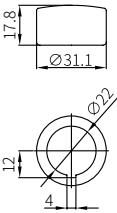
- IP65 protection structure with waterproof cap
- Unit: mm, For the detailed drawings, follow the Autonics web site.

Model	Applied switches	Dimensions	Appearance
SA-WP	Ø 22/25 mm Round non-illuminated / extended push button switches		
SA-WL	Ø 22/25 mm Round illuminated / extended push button switches		

Emergency Switch Nameplates (SA-N□)

- Unit: mm, For the detailed drawings, follow the Autonics web site.
- Standard color is yellow. Luminous nameplates are optional.

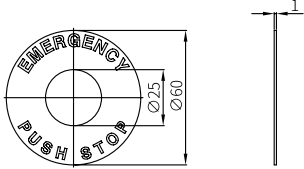
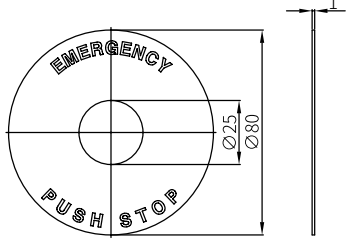
Model	Applied switches	Appearance
SA-NS	Ø 22/25 mm Emergency switches ⁰¹⁾	<ul style="list-style-type: none"> • D60 × d25 
SA-NL	Ø 22/25 mm Emergency switches	<ul style="list-style-type: none"> • D80 × d25 

01) Except Ø 22/25 mm Emergency switch D60.

Emergency Switch Protective Shrouds (SA-EG□)

- Protective shrouds to prevent accidental/incorrect operation.

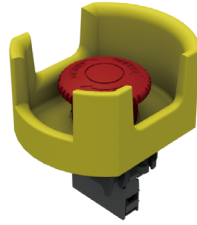
Model	Applied switches	Appearance
SA-EG1	Ø 22/25 mm Emergency switches ⁰¹⁾	
SA-EG2 / SA-EG3		

01) Except Ø 22/25 mm Emergency switch D60.

■ Dimensions

- Unit: mm, For the detailed drawings, follow the Autonics web site.
- SA-EG1

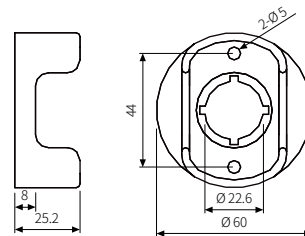

- SA-EG2 / EG3

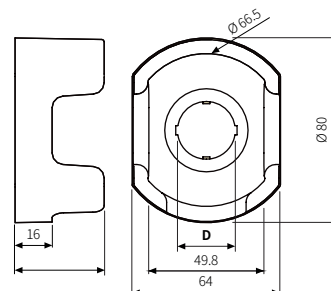

Model	D
SA-EG2	Ø 22.5
SA-EG3	Ø 25.5